

REPUBLIC OF LIBERIA

Ministry of Mines & Energy

P. O. Box 10-9024

1000 Monrovia 10

LIBERIA, WEST AFRICA



MINERALS AND MINING ACT 2000

CLASS B MINING LICENSE

License No: **AM2004321**

Authorisation is hereby granted to operate a Mine under and subject to the provisions of Minerals and Mining Act 2000 and the Regulations including the terms and conditions herewith attached. The license is granted to:

Name: **WEST AFRICAN MINING COMPANY LIBERIA LIMITED**

Registration/Identity No.: **FLAG RECEIPT #:700745; TIN:500902632**

Address: **KAKATA MINING DISTRICT, MARGIBI COUNTY**

Mineral to be mined: **BARITE**

County: **MARGIBI COUNTY**

Code: **700**

The Mining License covers approximately 98 Acres in area defined by the UTM coordinates of **SPATIAL REFERENCE (WGS84 UTM GRID ZONE 29N)** set forth on last page:

Mining District: **KAKATA MINING DISTRICT**

Date of issuance: **MAY 21, 2021**

Date of expiry: **MAY 20, 2026**

Place of issue: **Monrovia**

Unless this certificate is suspended or cancelled, it shall be valid for 5 YEARS from the date of issuance. License fees are required to be paid yearly within the license period.

SIGNED: _____

DIRECTOR OF MINES

APPROVED: _____

ASSISTANT MINISTER FOR MINES

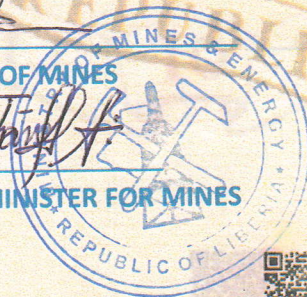



REPUBLIC OF LIBERIA

Ministry of Mines & Energy

P. O. Box 10-9024

1000 Monrovia 10

LIBERIA, WEST AFRICA



BASIC LAWS GOVERNING CLASS B MINING

1. Smuggling is an economic crime against the State.
2. License is granted to only Liberians of legal age.
3. Illicit mining is strictly prohibited. Violators found will forfeit mineral (gold/diamond) and tools by confiscation or fine and/or serve imprisonment.
4. Security for restoration of operation site shall be paid at each time a license hereunder is being issued.
5. Mining rights granted hereunder shall not be assignable or hypothecated but are transferable in case of death.

KIMBERLEY PROCESS REQUIREMENTS

The Kimberly process certification scheme which has been passed into law in Liberia requires the following steps for internal control and transparency in mineral production and trading activities:

1. All Miners are to be organized into mining cooperatives for internal control purposes.
2. There are heavy penalties for smuggling or any illicit activity in the mineral sector as stipulated by law. Illicit activity means transaction with unauthorized persons, conducting mineral operations without proper documentation, questionable activities as it relates to the mineral sector.
3. For transparency in mineral trade, the follow steps must be followed:
 - a) Miner gets serialized vendor forms from the Ministry of Lands, Mines & Energy/ KPC Database Office.
 - b) Miner transacts business (conducts trading) in the presence of the Mineral Inspector(s); Mineral Inspector(s) takes a copy of the transaction document(s) to the KPC Database Office in Monrovia for production data and verification. Miner retains one copy of vendor form.
 - c) The Broker / buyer takes two of the vendor forms, retains one and takes one to the exporter/dealer to whom he sells his diamonds previously bought from the miners.
 - d) The exporter/dealer takes his diamonds to the KPC Database Office where his form is verified with the Inspector's form. The Kimberley Process Certification process begins.

Procedure on Internal Control of Diamond Production in the Alluvial Sector Serialized Vendor Forms

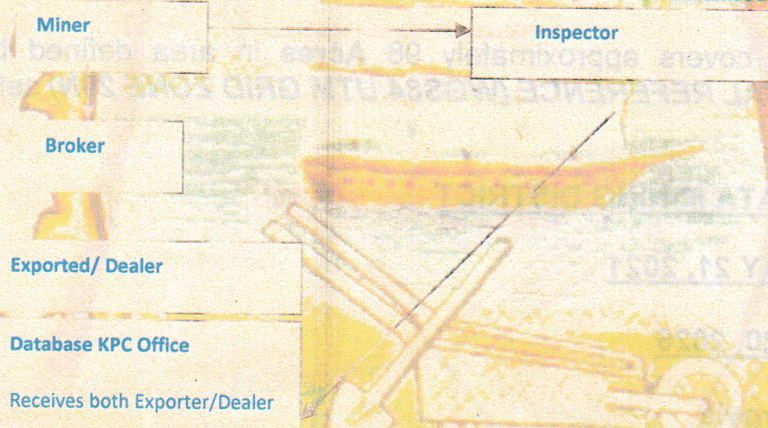

I, the undersigned swear to abide by these basic laws, and also agreed to become a member of the Ministry's mining cooperative Scheme

SIGNED: _____





REPUBLIC OF LIBERIA

Ministry of Mines & Energy

P. O. Box 10-9024

1000 Monrovia 10

LIBERIA, WEST AFRICA



AM2004321

West Africa Mining Company Ltd

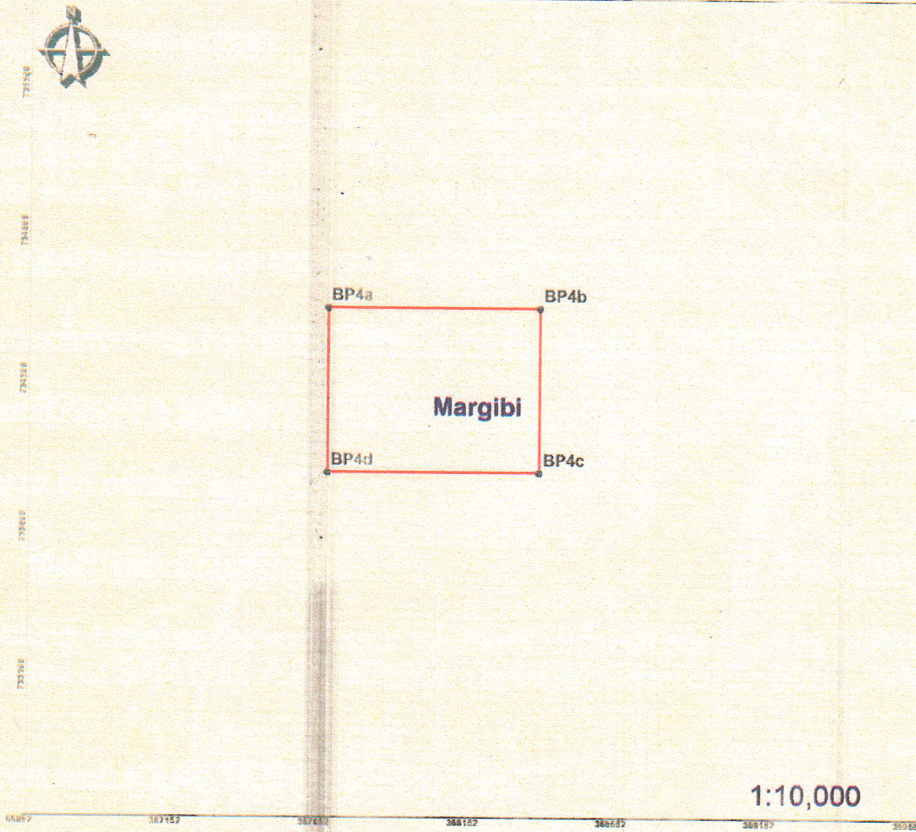

Legend

- WAMC_Pts
- ⊕ WAMC_Blocks

BLOCK 4

X	Y	Vertices
367658	734619	BP4a
368372	734619	BP4b
368372	734063	BP4c
367658	734063	BP4d

"Area Size=98 Acres

