



REPUBLIC OF LIBERIA

Ministry of Mines & Energy

P. O. Box 10-9024

1000 Monrovia 10
LIBERIA, WEST AFRICA



MINERALS AND MINING ACT 2000

CLASS B MINING LICENSE

License No: MBL 1485/15

Authorisation is hereby granted to operate a Miner under and subject to the provisions of Minerals and Mining Act 2000 and the Regulations including the terms and conditions herewith attached. The license is granted to:

Name: **LICHI INC.**

Registration/Identity No.: **FLAG RECEIPT # 582630 & TIN# 500115895**

Address: **SCHIEFFLIN TOWN, MARSHALL, MARGIBI COUNTY**

Mineral to be mined: **SAND ; SIZE OF PRODUCTION AREA : 50 ACRES**

County: **MARGIBI COUNTY** Code: **700**

Mining District: **KAKATA MINING DISTRICT**

Date of issuance: **31-JAN-2020**

Date of expiry: **30-JAN-2025**

Place of issue: Monrovia

Unless this certificate is suspended or cancelled, it shall be valid for 5 YEARS from the date of issuance. License fees are required to be paid yearly within the license period.

SIGNED: _____

DIRECTOR OF MINES

APPROVED: _____

ASSISTANT MINISTER FOR MINES

License No: MBL 1484/15: LICHI INC.



REPUBLIC OF LIBERIA

Ministry of Mines & Energy
P. O. Box 10-9024
1000 Monrovia 10
LIBERIA, WEST AFRICA

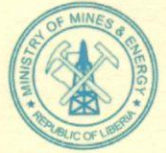

BASIC LAWS GOVERNING CLASS B MINING

1. Smuggling is an economic crime against the State.
2. License is granted to only Liberians of legal age.
3. Illicit mining is strictly prohibited. Violators found will forfeit mineral (gold/diamond) and tools by confiscation or fine and/or serve imprisonment.
4. Security for restoration of operation site shall be paid at each time a license hereunder is being issued.
5. Mining rights granted hereunder shall not be assignable or hypothecated but are transferable in case of death.

KIMBERLEY PROCESS REQUIREMENTS

The Kimberly process certification scheme which has been passed into law in Liberia requires the following steps for internal control and transparency in mineral production and trading activities:

1. All Miners are to be organized into mining cooperatives for internal control purposes.
2. There are heavy penalties for smuggling or any illicit activity in the mineral sector as stipulated by law. Illicit activity means transaction with unauthorized persons, conducting mineral operations without proper documentation, questionable activities as it relates to the mineral sector.
3. For transparency in mineral trade, the follow steps must be followed:
 - a) Miner gets serialized vendor forms from the Ministry of Lands, Mines & Energy/ KPC Database Office.
 - b) Miner transacts business (conducts trading) in the presence of the Mineral Inspector(s); Mineral Inspector(s) takes a copy of the transaction document(s) to the KPC Database Office in Monrovia for production data and verification. Miner retains one copy of vendor form.
 - c) The Broker / buyer takes two of the vendor forms, retains one and takes one to the exporter/dealer to whom he sells his diamonds previously bought from the miners.
 - d) The exporter/dealer takes his diamonds to the KPC Database Office where his form is verified with the Inspector's form. The Kimberley Process Certification process begins.

Procedure on Internal Control of Diamond Production in the Alluvial Sector Serialized Vendor Forms

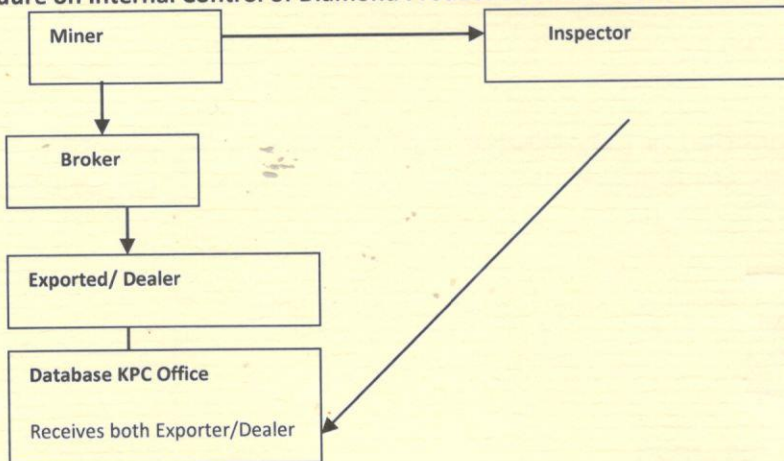

OK
Mr. Charles
April 9, 2020

I, the undersigned swear to abide by these basic laws, and also agreed to become a member of the

Ministry's mining cooperative Scheme

SIGNED: _____

License : MBL 1485/15



General Fees Payments **Locations** Documents History

Base 50 Acres

Regions Margibi County
Kakata Mining District

Claim No.

Recommend Available-adjusted

Format: **ESI Shapefile** | Projections: **EPSG:4326**

Other licenses: **Active License**

[Download GIS data](#)

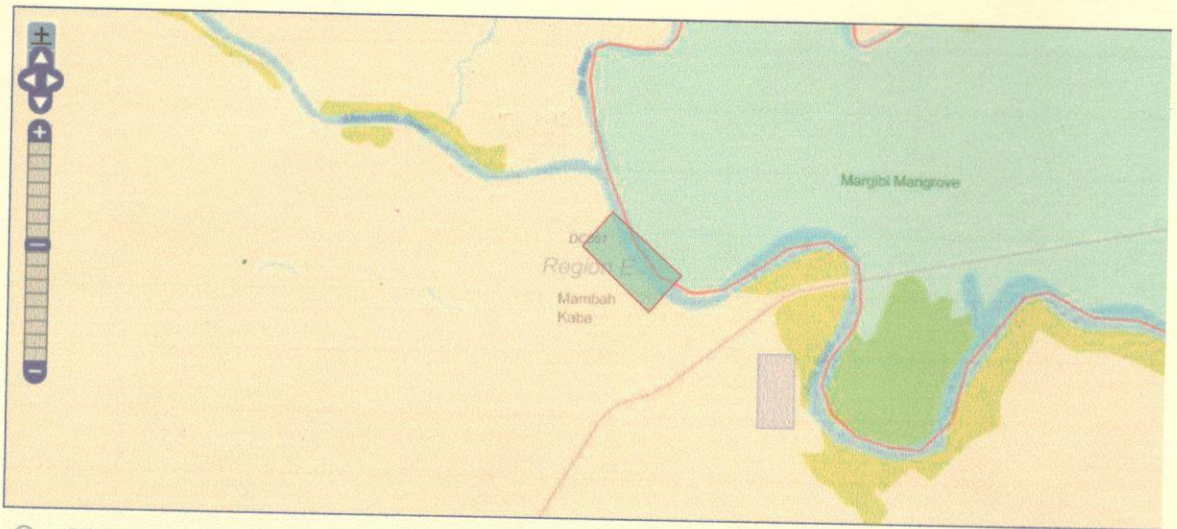

- GIS Coordinates
- B1: 329623.0000, 689323.0000, 29N
 - B2: 330094.0000, 688900.0000, 29N
 - B3: 329875.0000, 688649.0000, 29N
 - B4: 329422.0000, 689090.0000, 29N

WORKFLOW

- All Workspaces -

Tasks

Area Search

Applications

Licenses

CORRESPONDENCE

DATA MANAGEMENT

ONE CLASS B MAP OF LICHI INC.
 Situated Near Scheiffelin Town, Lower Margibi, Kakata
 Mining District, Margibi CO

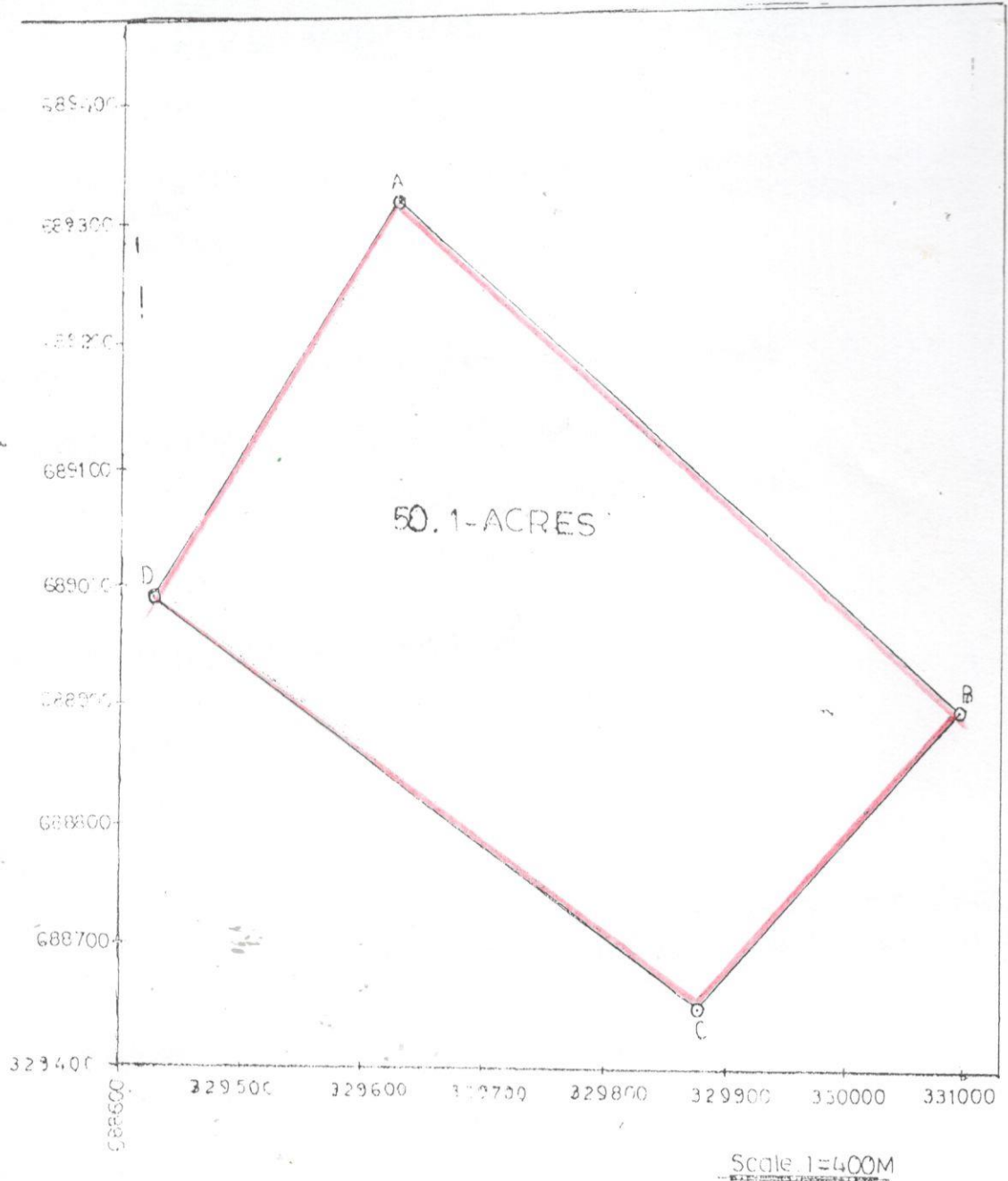

BUREAU OF MINES			UTM-COORDINATE		
PREPARATION	SIGNATURE	DATE	Sta	Easting	Northing
Surveyed by	Wellington Wuelleh	Sept 5, 2020	A	329623	689323
Drawn by	Alexander C. Roberts	Sept 7, 2020	B	330000	688900
Approved by:	Wellington Wuelleh	Sept 7, 2020	C	329875	688549
			D	329422	688990

TAX PAYMENT RECEIPT

March 13 2020



LIBERIA
REVENUE AUTHORITY
DOMESTIC TAX DEPARTMENT



Document No
029612589

TIN: **500115895** RECEIPT NO: 582630
TAXPAYER: LICI INC. DATE: March 13 2020
BRANCH: LICI INC. (ING) LICENSE

COMM. BANK MGR. CHEQUE 0032734 GN

Total Payment **10,000.00 USD**
10,000.00 USD

Tax Type	Tax Period	Bill No	Assmt No	Tax USD	Penalties USD	Interests USD	Total USD
LME-SAND DREDGIN	January 2020		738309	10,000.00	0.00	0.00	10,000.00

Amount in Words: Ten Thousand United States Dollars ... United States Dollars ...00/100

TELLER 64

2020 MAR 13 A 11: 59
CENTRAL BANK OF LIBERIA

SEKOU SIRLEAF

BPS No: 029612589

Payment Location: CENTRAL BANK/MC

Section of the Book

Document No
029612589

029612589



Tax Period
January 2020
Tax Centre
TEAM ONE - MTD
Document No
738309

TIN: 500115895
Tax Account: 109127
Tax Type: LME-SAND DREDGING LICENSE
Assmt No:

Amount of Tax Paid

Date

Cashier's Tax Centre
Signature and Stamp

 REPUBLIC OF LIBERIA LIBERIA REVENUE AUTHORITY DOMESTIC TAX DEPARTMENT		Document No	*029612589* 029612589	Filing Due Date: December 31 2020 Filing Date: March 13 2020 Payment Due Date: December 31 2020

BANKING PAYMENT SLIP (ASSESSMENT) FOR LME-SAND DREDGING LICENSE

TIN	Tax Type	Tax Account	Tax Period	Tax Centre
500115895	LME-SAND DREDGING LICENS	109327 Assess No: 738309	1 2020 01-01-2020 To: 12-31-2020	TEAM ONE - MTD

LICHI INC
LICHI INC
 CAREY STREET, Carey & Mcdonald Street
 Monrovia
 District #2, Montserrado
 Liberia

This assessment notice, obtained from the Analyst, must be presented to the Central Bank of Liberia Teller for payment. Any alteration of information on this assessment is punishable under the Liberian Revenue Code (LRC). Furthermore, according to section 1900 (Tax Evasion) "Any person who wilfully evades or defeats any tax imposed under any of the provisions or the Tax Code or under any of the provision, or the payment thereof shall be guilty of a Felony and upon conviction in addition to any other sanctions provided by law, shall be fined not more than L\$200,000 or imprisoned not more than five (5) years, or both."

Payment Summary

	Charge Calculated	Payment Applied	Credit Applied	Refund Applied	Amount Due
Tax	9,999.00	0.00	0.00	0.00	9,999.00 USD
Penalty	0.00	0.00	0.00	0.00	0.00 USD
Interest	0.00	0.00	0.00	0.00	0.00 USD
Total	9,999.00	0.00	0.00	0.00	9,999.00 USD
Total Due For The Period (Tax + Penalties + Interest):					0.00 USD
Credit To Carry Forward:					0.00 USD
Overpayment For The Period:					0.00 USD

Section of the Bank



Document No
029612589
 029612589

Tax Period
 January 2020
 Tax Centre
 TEAM ONE - MTD
 Assessment No
 738309

TIN: 500115895
 Tax Account: 109327
 Tax Type: LME-SAND DREDGING LICENSE
 Account No:

Amount of Tax Paid: _____
 Date: _____

Cashier's Tax Centre: _____
 Signature and Stamp: _____



REPUBLIC OF LIBERIA
MINISTRY OF MINES AND ENERGY

P.O. BOX 10-9024
 1000 MONROVIA 10, LIBERIA, WEST AFRICA
 TEL: (231) 07701 32540

CLASS B PAYMENT FORM

Date: 09 Mar 2020

The Honorable
 The Commissioner of Domestic Tax Department
 Liberia Revenue Authority
 Monrovia, Liberia

Mr. Commissioner:

Application has been filed by: **LICHI INC.**

to mine **SAND** within the County of **MARGIBI** Republic of Liberia.

AMOUNT TO BE PAID: 10,000.00 USD
Ten Thousand United States Dollars

Payment Period: **For One year**

The receipt for this payment should be delivered to the Cadastre Office within **two weeks** of the issued date of this letter.

Description: **CLASS B MINING LICENSE**

License Number: **MBL 1485/15**

Location: **SCHIEFFLIN TOWN, MARGIBI, REPUBLIC OF LIBERIA**

SIGNED: _____
 DIRECTOR OF MINES

APPROVED: _____
 COMPTROLLER

Handwritten in red ink:
 [Signature]
 M. C. [Signature]
 March 17, 2020