



REPUBLIC OF LIBERIA

Ministry of Mines & Energy

P. O. Box 10-9024

1000 Monrovia 10
LIBERIA, WEST AFRICA



MINERALS AND MINING ACT 2000

CLASS B MINING LICENSE

License No: **AM2007823**

Authorisation is hereby granted to operate a Mine under and subject to the provisions of Minerals and Mining Act 2000 and the Regulations including the terms and conditions herewith attached. The license is granted to:

Name: **J. M. MINING INCORPORATED**

Registration/Identity No.: **FLAG RECEIPT #: 1280939/118444; TIN#: 501368432**

Address: **WITHIN MASSAWO, ZORZOR MINING DISTRICT, REPUBLIC OF LIBERIA**

Mineral to be mined : **GOLD**

County: **LOFA** Code: **100**

The Mining License covers approximately 100 Acres in area defined by the UTM coordinates of **SPATIAL REFERENCE (WGS84 UTM GRID ZONE 29N)** set forth on the last page:

Mining District: **ZORZOR MINING DISTRICT**

Date of issuance: **JUNE 29, 2023**

Date of expiry: **JUNE 28, 2028**

Place of issue: **MONROVIA, REPUBLIC OF LIBERIA**

Unless this certificate is suspended or cancelled, it shall be valid for 5 YEARS from the date of issuance. License fees are required to be paid yearly within the license period.

SIGNED: 
ASSISTANT MINISTER FOR MINES

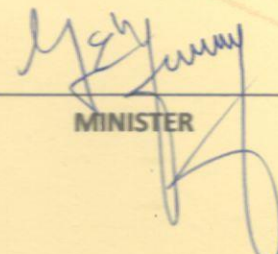
APPROVED: 
MINISTER





REPUBLIC OF LIBERIA

Ministry of Mines & Energy

P. O. Box 10-9024

1000 Monrovia 10
LIBERIA, WEST AFRICA

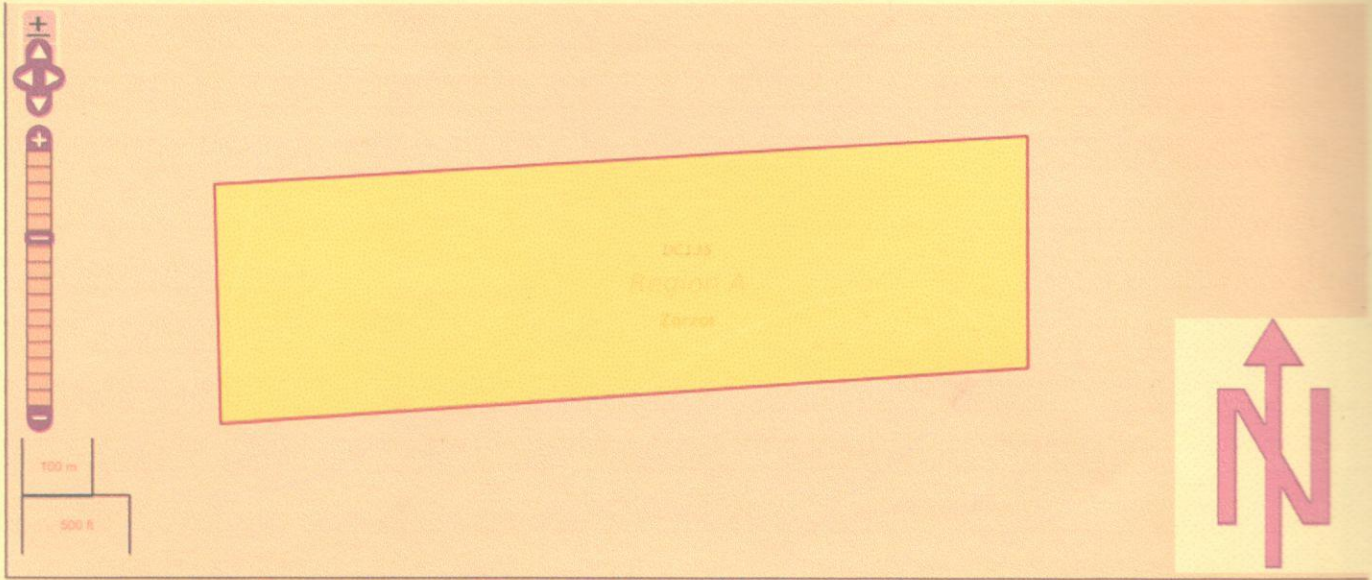

GIS Coordinates

A1: 429967.0000, 845230.0000, 29N

A2: 431134.0000, 845298.0000, 29N

A3: 431134.0000, 844962.0000, 29N

A4: 429975.0000, 844883.0000, 29N

Signed: _____
Director of Mines

OK
M. C. Chen
July 18, 2023



REPUBLIC OF LIBERIA

Liberia Revenue Authority

DTD

Visa and Stamp

Date of payment

06/29/2023

Received by

Bank cheques \$10,000.00 USD

N° cheque : 80115774

Bank : ECOBANK LIBERIA LIMITED

Yassah Margai

Payment Receipt

Bill number

1280939/118444

105292

Receipt TIN 501368432 J.M. MINING INCORPORATED (J.M. MINING INCORPORATED)

Activity 0399 OTHER MINING AND QUARRYING N.E.C. (Other mining and quarrying n.e.c.)

Date of entry into operation 14/04/2022

Address COUNTRY : LIBERIA, COUNTY : Montserrado, DISTRICT : DISTRICT #10, CITY/TOWN :

Act code

The following transactions are in good standing

LME-GOLD CLASS B LICENSE FEES

06/29/2023

TAX DUE

\$10,000.00

Currency: DOLLAR US (USD)

Operation performed by

Yassah Margai



BRANCH

Monrovia, June 29, 2023

Amount paid

Amount in words

TEN THOUSAND USD

\$10,000.00

Edited by LRA

P.O. Box 10 MONROVIA - EMAIL : info@mfdp.gov.lr
Website : http://revenue.lra.gov.lr

6057729119194

2023

06/29/2023

Code	Tax / Fee Type	Tax/Fee due	Penalty	Interest	Total
12556 88	LME-GOLD CLASS B LICENSE FEES	\$10,000.00	\$0.00	\$0.00	\$10,000.00

Amount on hand to pay :

\$10,000.00 USD

Comment : Nothing

NB: The total amount of the Bill must be paid in full.

Section of the Bank



Document No :105292

Tax Period

2023

Tax Center

MEDIUM TAX DIVISION

TIN : 501368432

Tax/fee type : LME-GOLD CLASS B LICENSE FEES

Amount paid:

Cashier :

Signature :



REPUBLIC OF LIBERIA
 MINISTRY OF MINES AND ENERGY
 P.O. BOX 10-9024
 1000 MONROVIA 10, LIBERIA, WEST AFRICA
 TEL: (231) 07701 32540



CLASS B LICENSE PAYMENT FORM

Date: JUNE 16, 2023

The Honorable
 The Commissioner of Domestic Tax Department
 Liberia Revenue Authority
 Monrovia, Liberia

Mr. Commissioner:

Application has been filed by: J. M. MINING INCORPORATED

To mine GOLD within the County of LOFA, Republic of Liberia.

AMOUNT TO BE PAID: 10,000.00 USD
Ten Thousand United States Dollars

Payment Period: For One year

The receipt for this payment should be delivered to the Cadastre Office within two weeks of the issued date of this letter.

Description: CLASS B MINING LICENSE

License Application Number: APL-I-6458

Location: Within Massawo, Zorzor Mining District, Republic of Liberia

DIRECTOR OF MINES

APPROVED: _____

COMPTROLLER

OK
 M. Chavis
 July 18, 2023

MB: APT-I-6458

06/07/2023



REPUBLIC OF LIBERIA
MINISTRY OF MINES AND ENERGY
P.O. BOX 10-9024
1000 MONROVIA 10, LIBERIA

Customer Service Numbers: 0880762601/0775352427



Two (2)
Passport
Size Photos

APPLICATION FORM & BUREAU OF MINES CLEARANCE

Name of Applicant(s): J.M Mining Inc.
 Administrative Mining District Code: A-08
 Administrative Mining District/County: Zorzor Mining District
 Name of stream/River/Creek/residue: VIA River

New license	<input checked="" type="checkbox"/> Yes	No <input type="checkbox"/>
License renewal	<input type="checkbox"/> Yes	No <input checked="" type="checkbox"/>
Site Surveyed	<input type="checkbox"/> Yes	No <input checked="" type="checkbox"/>

Name of Surveyor: _____ Date of Survey: _____

UTM Coordinates (WGS 84/29N):	Easting	Northing
		<u>429967</u>
	<u>431134</u>	<u>845298</u>
	<u>431134</u>	<u>844962</u>
	<u>429975</u>	<u>844883</u>

Address

Street/Community: Massawo City/Town: Massawo Town
 District: Zorzor County: LOFA
 Phone No: _____ Mobile No: _____
 Nationality: _____ Email Address: _____
 Tax Identification Number (TIN): _____

Previous Site reclamation: Mining Site Reclaimed Mining Site Not Reclaimed

Number of Claims Owned by applicant:
 1 2 3 4

Claim Number(s):
 1. _____
 2. _____
 3. _____
 4. _____

Mineral(s) Type: Diamond ; Gold ; Others (specify): _____
 License Types: ((Mining: Class C ; Class B ; Quarry ; Sand ; Laterite); (Jewelry: Class A ; Class B ; Class C ; Semi-Precious ; Cut & Polish); Industrial Mining: (Class B ; Class C); Broker ; Dealer/Export ; Scrap ;)

Statement of recommendation by Mining Agent:
 AREA(S) VACANT & UNSURVEY PORTION
 RENEWAL
 REQUIRES DELINQUENT FEES PAYMENT
 REQUIRES REDEMARCATON

Date: April 14, 2022 Time: 2:45 pm
 Principal Applicant Name: J.M Mining Inc. Signature: J.M Inc
 Mining Agent Name: Jonathan S.B Kwenah Signature: [Signature]

Note: This document is not a License and Must be used only as a clearance and it is valid for one week (1wk) as of the issuance date or as much time as may be justifiable and accepted by the Director of Mines.
 *** No Class C Clearances be granted on Hill ***

Mr. Pency please process for Class B License.
 [Signature]

DOM please act accordingly.
 [Signature]

J.M.Mining Inc

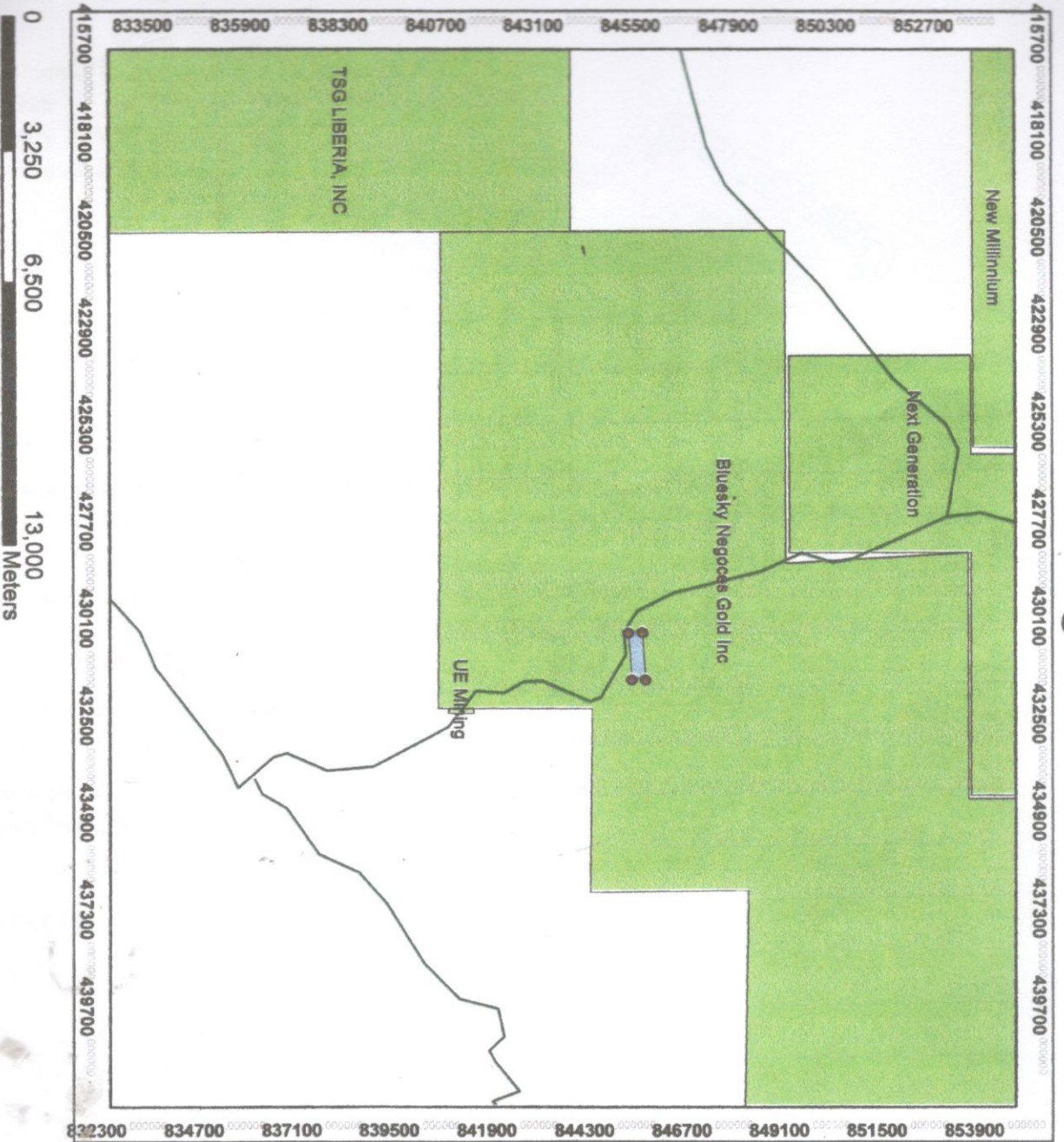

Legend

- JMML_Points
- rivers
- J.M.Mining_Block
- county_2007-ed09
- Existing Licenses_01_2022

ID	E	N
1	429967	845230
2	431134	845298
3	431134	844962
4	429975	844883

Area Size: 98 Acres

'Encumbered by Bluesky Gold Negoces Inc Licenses with Notarised Understanding'.

T. Glatts / April 22, 2022

Hon. Gesler E. Murray
Minister
Ministry of Mines and Energy
Republic of Liberia

April 9, 2022



Subject: Letter of Authorization

Dear Honorable Minister,

We bring you greetings and wish to inform of our decision to allow J.M Mining Incorporation to apply for a prospecting license within within MEL 9002921 granted to **BLUESKY GOLD NEGOCES INC.**

I, Dominic AL Dunbar Project geologist of Bluesky Gold Negoces Inc. A Holder of an exploration license **MEL 9002921**, have agree for J.M Mining Incorporation to considered to apply for a prospecting license and subsequently, a Class B Mining license within our Mineral Exploration License located in Zolowo, Zorzor District, Lofa County, Liberia.

Honorable Minister, I also want to assure your honorable office that the issuance of this license will not affect our annual payment toward the surface rental and exploration license.

Honorable Minister, This letter as undersigned is my (our) **Consensus** to the Ministry of Mines and Energy for the above request.

BLOCK ONE

ID	X	Y
1	429967	845230
2	431134	845298
3	431134	844962
4	429975	844883

SIGNED: AL DOMININIC DUNBAR

Project GEOLOGIST

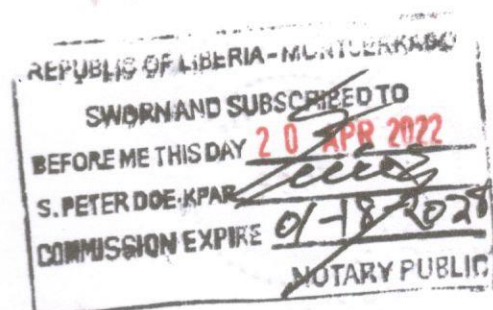

The management of J.M Mining Inc.
Republic of Liberia
March 17 2022

Dear J.M Mining Company Inc.,

Your letter dated February 17, 2022 was received and approved for you to carry on your prospecting and subsequent Class B within the MEL 9002921 Lofa county. I have already sent a letter of consent to the Ministry of Mines

Kind regards.

ID	X	Y
1	429967	845230
2	431134	845298
3	431134	844962
4	429975	844883

SIGNED: AL Dominic DUNBAR



Project Geologist/0777404533

RECEIVED
07 JUN 2023

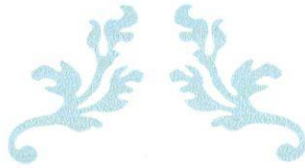

J.M. Mining Incorporated

**TECHNICAL WORK
PLAN**



JANUARY 26, 2023

**ZORZOR DISTRICT, LOFA
COUNTY**

Contents

1.0 INTRODUCTION	1
2.0 PROJECT LOCATION	1
2.1 APPLICATION	3
2.2 DEMARCATION OF LAND	3
2.2.1 RELIEF AND GEOLOGY	3
2.2.2 GEOLOGY OF PROJECT AREA	4
3.0 INVESTMENT COST FOR THE PROJECT	5
4.0 ENVIRONMENTAL STUDIES	6
5.0 PREPARATION OF CLASS B MINING LICENSE	6
6.0 MINING EQUIPMENT	6
7.0 EMPLOYMENT	7
9.0 ENVIRONMENTAL ISSUES AND CONSIDERATIONS	9
10.0 PROJECT DESIGN	10
11.0 PRODUCTION RATE/MINING METHOD & STOCKPILE	10
11.1 PRODUCTION	10
11.2 MINING METHODS	11
11.3 STOCKPILE	12
11.4 TAILING STORAGE FACILITY (TSF)	12
12.0 OCCUPATIONAL HEALTH & SAFETY	12
12.1 PERSONAL PROTECTIVE EQUIPMENT	14
12.2 INSTRUCTION	15
12.3 PERSONAL CLOTHING AND ACCESSORIES	15
13.0 BENEFITS OF THE PROJECT	15
14.0 MINE CLOSURE	16
15.0 CONCLUSION	16

1.0 INTRODUCTION

In enactment to the Mineral and Mining Laws of Liberia of 2000, **J. M. Mining Incorporated** presents a Technical work program for a Class B Mining operation in Zorzor Mining District, Lofa County, Liberia. This work program is requested by the Ministry of Mines and Energy as a precondition for the granting of a Class B Mining License to the company.

This Technical work program as requested by the Ministry of Mines & Energy is centered on the desire to have **J. M. Mining Incorporated** achieve its objective in a timely manner and to employ the best international standard mining methods. This Technical Work Program contains elements which provide the outline of activities and outflow commitments for the mining operations. It shows a brief description of the company's technical and financial proficiencies as required under the Mineral and Mining Laws of Liberia of 2000.

J. M. Mining Incorporated is legally registered under the business laws of the Republic of Liberia and wishes to get involved in semi-mechanized mining of Gold in Zorzor Mining District, Zorzor District, Lofa County, Liberia. This company has already acquired a prospecting License, done prospecting, reported on the prospecting activities and is now seeking a Class B Mining License. It has established an office and has mobilized all relevant resources including office facilities, transport equipment, earth moving equipment, etc for the operations.

2.0 PROJECT LOCATION

J. M. Mining Incorporated project area is geographically located in the political subdivision of Lofa County. It is Southwest of the Lofa Quadrangle, and about 131 km southwest off Voinjama; it is accessed via an asphaltic road from Monrovia to Gbarnga City, and through a final stretch lateritic road to the proposed project site in Zolowo Town.

The License Area is accessible by road all year round except for intensively rainy days in the month of July and September. At this time the road becomes challenging for vehicular movement.



Figure I: Location and Access Map of the Proposed License Area

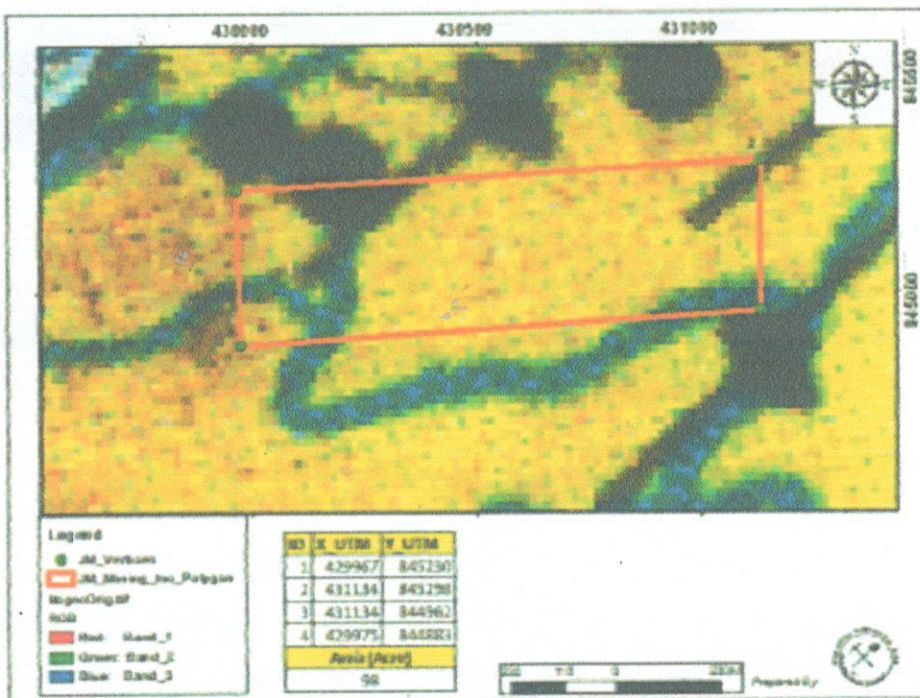

Figure II: J. M. Mining Incorporated Proposed License and Vertices

2.1 APPLICATION

In compliance with the Minerals and Mining Laws of Liberia of 2000, the Management of **J. M. Mining Incorporated** is submitting a letter of intent to the Ministry of Mines and Energy with the relevant attachments requesting the issuance of a Class B Mining License for the mining of gold on a semi-mechanized scale.

2.2 DEMARCATION OF LAND

The requirement to have the mining property surveyed as a precondition for the granting of a Class B license will be certified as soon as the Ministry gives approval. A licensed surveyor from the Bureau of Mines will facilitate the survey of the property and establish the boundaries of the area. A map to this effect will be produced after the survey is completed.

2.2.1 RELIEF AND GEOLOGY

The relief in most of the area is about 350 meters and consists of very steep hills, approximately 350 to 400 meters above sea level- The most prominent topographic feature in proximity to the license area is the Kpo Mountain Range. The major drainage basins in the area are the southeast flowing Via River and the Laya Creek. The proposed license is situated at the confluence of both waters which drained the surrounding mineralized higher lands. Minor drainage is mostly swamp, with no discharge in the dry season, but remains soft and damp. Vegetation over much of the area is dense second growth on old farms; only small patches of high forest remain.

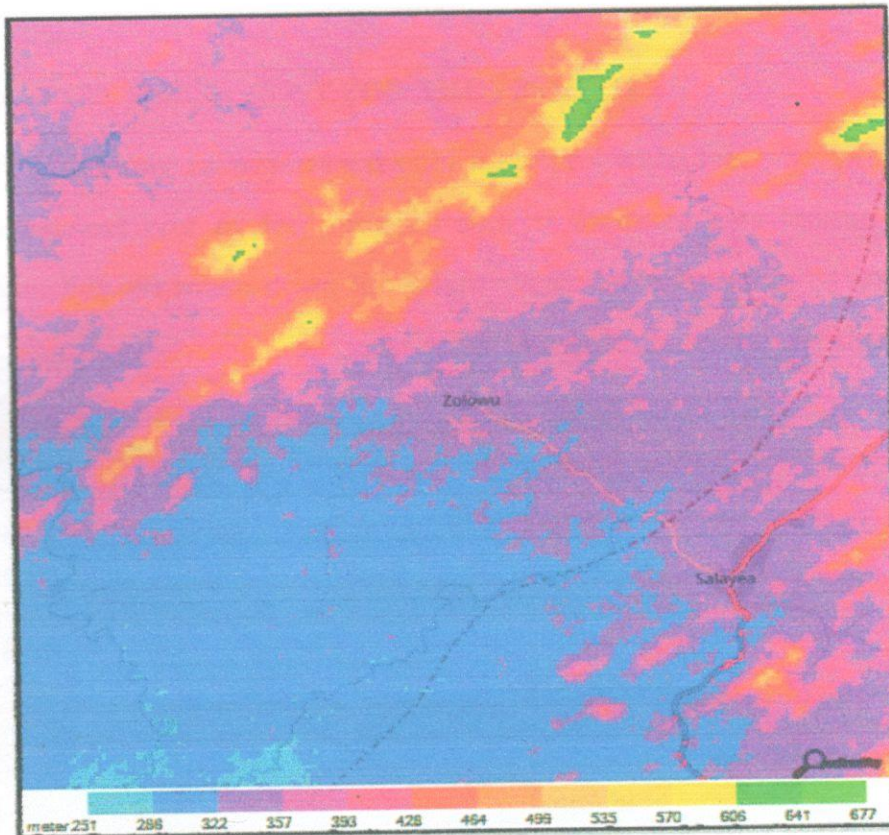

Figure III: Relief Map of J. M. Mining Inc. Proposed License Area

2.2.2 GEOLOGY OF PROJECT AREA

JM Mining Incorporated proposed License Area is entirely underlain by rocks of the Liberian Age Province (2700ma), and lie in the Zorzor Quadrangle. The structural trend of rocks in the proposed License area is principally northeast, and a number of minor north to northwest trending structures. These rocks are dominantly granitic gneiss light-colored, medium to coarse grained banded biotite-bearing gneiss; predominantly granodiorite, but ranging in composition from granite to granodiorite; magnetic and aerial photographic trends are parallel to regional structural trend.

3.0 INVESTMENT COST FOR THE PROJECT

M. J. Mining Incorporated gold mine project in this year will have to operate with the estimated investment cost of five hundred sixteen thousand five hundred eighty five United States Dollars (\$516,585.00) which cover the following assorted items and salary payment.

Description	unit	qty	rate	Amount	Total
License Fees	Annual	1	10,000	10,000	10,000
Sub total- Land Demarcation					10,000.00
Environmental Studies					
PA Permit Fees	annual	1	15,025	15,025	15,025
PA Project Brief	Lumpsum	1	2,000	2,000	2,000
Sub Total - Environmental Studies					17,025.00
Equipment					
Supporting logistics	Lumpsum	1	300,000	300,000	300,000
Sub total- Equipment					300,000.00
Employment					
Local Laborers (Unskilled)	monthly	6	150	900	10,800
Local Labourers (Skilled)	monthly	15	350	5,250	63,000
Geological Consultant	monthly	1	500	500	6,000
Utility	monthly	2	75	150	1,800
Sub Total Employment					81,600.00
Social Responsibilities					
County Officials Purse	quarterly	4	1,000	1,000	4,000
Community Development	monthly	12	500	500	6,000
Sub Total Social Responsibilities					10,000.00
Logistic					
Light/heavy duty oil	drums	2	2,160	2,160	4,320
Fuel for heavy moving equipment	drums	14	480	6,720	80,640
Other Lubricants	drums				3,500
Sub Total Logistic					88,460.00
Construction/Maintenance					
Administrative site	Lumpsum	1	4,500	4,500	4,500
Residential site	Lumpsum	1	5,000	5,000	5,000
Sub Total					9,500.00
Grand Total					516,585.00

Table I: J. M. Mining Incorporated Investment Cost

4.0 ENVIRONMENTAL STUDIES

The management of **M. J. Mining Incorporated** will hire the services of a Consultancy Firm to conduct a comprehensive Environmental assessment of the project area, interview citizens of the project area, collect random sampling and gather photographs for the preparation of a full scope Environmental Impact Report and Environmental Management Plan known as the Project Brief. The studies will also involve Reclamation plans (Backfilling, Spraying of topsoil, Replanting of trees -if the need exists to have the native vegetation restored). The consultancy will continue to provide environmental guidance for the Company.

5.0 PREPARATION OF CLASS B MINING LICENSE

Upon the submission of all requirements to the Ministry of Mines and Energy, it is our strongest belief that the Class B Mining License will be granted.

6.0 MINING EQUIPMENT

The Management has purchased, ready for use, relevant and modern mining equipment that are effective in Modern mining operations. These equipment will be used for the project. They are as follows:

2 (Two) Caterpillars track Excavator 300D (1 Cat & 1 HYUNDAI);

1 (one) YC Diesels 750hp 6 inch water pumps

3 (three) slice steel washing sluice boxes with crushing facilities;

2(two) Land Cruiser 4x4 Diesel Pickup Set

PPEs

Supporting Logistics



Figure IV: 2 (Two) Caterpillars track Excavator 300D (1 Cat & 1 HYUNDAI) procure for the project;

7.0 EMPLOYMENT

The company intends to employ about twenty eight (28) persons during its operation for its first year. Bulk of the work force (casual laborers) will be recruited from the affected villages and towns. The employment activity has to correspond to the memorandum of