



# REPUBLIC OF LIBERIA

Ministry of Mines & Energy

P. O. Box 10-9024

1000 Monrovia 10

LIBERIA, WEST AFRICA



## MINERALS AND MINING ACT 2000

### CLASS B MINING LICENSE

**License No: AM2005020**

Authorisation is hereby granted to operate a Mine under and subject to the provisions of Minerals and Mining Act 2000 and the Regulations including the terms and conditions herewith attached. The license is granted to:

Name: **INLAND INVESTMENT INC.**

Registration/Identity No: **FLAG RECEIPT #: 1300727; TIN: 500733986**

Address: **BUCHANAN HIGHWAY, GRAND BASSA, REPUBLIC OF LIBERIA**

Mineral to be mined: **SAND**

County: **Grand Bassa**

Code: **600**

Order	Easting	Northing
1	385375	660938
2	385969	661553
3	386566	661554
4	385749	660765

The Mining License covers approximately 99 Acres in area defined by the UTM coordinates of **SPATIAL REFERENCE (WGS84 UTM GRID ZONE 29N)** See final page:

Date of issuance: **28 FEBRUARY 2020**

Date of expiry: **27 FEBRUARY 2025**

Place of issue: **Monrovia**

Unless this certificate is suspended or cancelled, it shall be valid for 5 YEARS from the date of issuance. License fees are required to be paid yearly within the license period.

SIGNED: \_\_\_\_\_

**ASSISTANT MINISTER FOR MINES**

APPROVED: \_\_\_\_\_

**MINISTER**





# REPUBLIC OF LIBERIA

Ministry of Mines & Energy

P. O. Box 10-9024

1000 Monrovia 10

LIBERIA, WEST AFRICA



## Inland Investment Inc.

384800 385000 385400 385800 386200 386600 387000

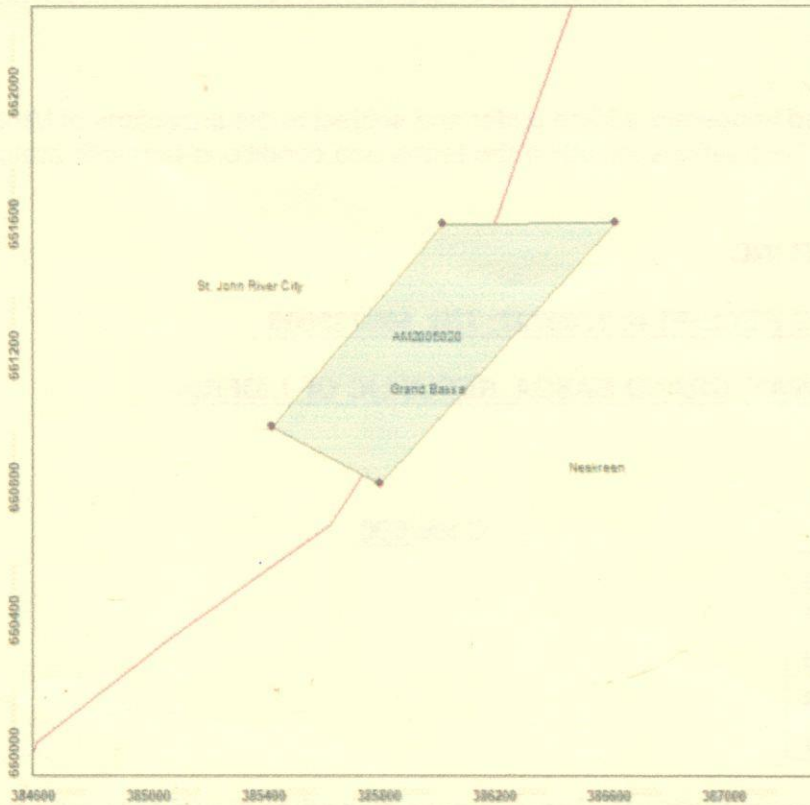

### Legend

- Inland\_Pts
- Inland\_Block
- district\_2007-ed09
- county\_2007-ed09

ID	E	N
1	385375	660938
2	385969	661553
3	386566	661554
4	385749	660765

Area Size: 99 Acres

Signed:

*P. Fully* 12/05/23

Director of Mines





REPUBLIC OF LIBERIA

Liberia Revenue Authority

DTD

Visa and Stamp

Date of payment

11/30/2023

Received by

Bank cheques \$10,000.00 USD

N° cheque : 000017030

Bank : GN BANK

*Sekou Sirleaf*

Payment Receipt

Bill number

1300727/137773

137979

Receipt TIN 500733986 INLAND INVESTMENT INC. (INLAND INVESTMENT INC)

Activity 0899 OTHER MINING AND QUARRYING N.E.C. (Other mining and quarrying n.e.c.)

Date of entry into operation 09/01/2018

Address COUNTRY : Liberia, COUNTY : Grand Bassa, DISTRICT : District # 2, CITY/TOWN : B

Act code

The following transactions are in good standing

LME - Other Fees And Charges	11/30/2023	TAX DUE	\$10,000.00
------------------------------	------------	---------	-------------

DOLLAR US (USD)

Operation performed by

Sekou Sirleaf



Amount settled

Amount in words

TEN THOUSAND USD

Monrovia, November 30, 2023

Edited by LRA

P.O.Box 10 MONROVIA - EMAIL : info@mfdp.gov.lr  
Website : http://revenue.lra.gov.lr

Tax account	Period	Amount
60165254180832	2023	11/30/2023

Code	Tax / Fee Type	Tax/Fee due	Penalty	Interest	Total
14783 80	LME - Other Fees And Charges	\$10,000.00	\$0.00	\$0.00	\$10,000.00

Amount on hand to pay :

\$10,000.00 USD

Comment : Nothing

NB: The total amount of the Bill must be paid in full.

Section of the Bank



Document No :137979

Tax Period

2023

Tax Center

SMALL TAX DIVISION

TIN : 500733986

Tax/fee type : LME - Other Fees And Charges

Amount paid: .....

Cashier : .....

Signature :

*2023/03/300727*



**REPUBLIC OF LIBERIA**  
**MINISTRY OF MINES AND ENERGY**  
P.O. BOX 10-9024  
1000 MONROVIA 10, LIBERIA, WEST AFRICA  
TEL: (231) 07701 32540



**CLASS B LICENSE PAYMENT FORM**

**Date: 2023-11-23**

The Honorable  
The Commissioner of Domestic Tax Department  
Liberia Revenue Authority  
Monrovia, Liberia

Mr. Commissioner:

Application has been filed by: **INLAND INVESTMENT INC.**

to mine **SAND** within the County of **GRAND BASSA** Republic of Liberia.

**AMOUNT TO BE PAID: 10,000.00 USD**  
**Ten Thousand United States Dollars**

Payment Period: **FROM FEB 2023 TO FEB 2024**

The receipt for this payment should be delivered to the Cadastre Office within two weeks of the issued date of this letter.

Description: **CLASS B MINING LICENSE**  
License Number: **RENEWAL AM2005020**  
Location: **WITHIN NEEKREEN DISTRICT, ST. JOHN RIVER, REPUBLIC OF LIBERIA**

  
\_\_\_\_\_  
**DIRECTOR OF MINES**

**APPROVED:** \_\_\_\_\_

  
**COMPTROLLER**

500733986



ONE CLASS B MAP OF INLAND INVESTMENT, INC.  
 Situated 2.5 Kilometers Southwest Of The St. John River Bridge, On The  
 Buchanan Highway, District No. 3 Mining, Grand Bassa County

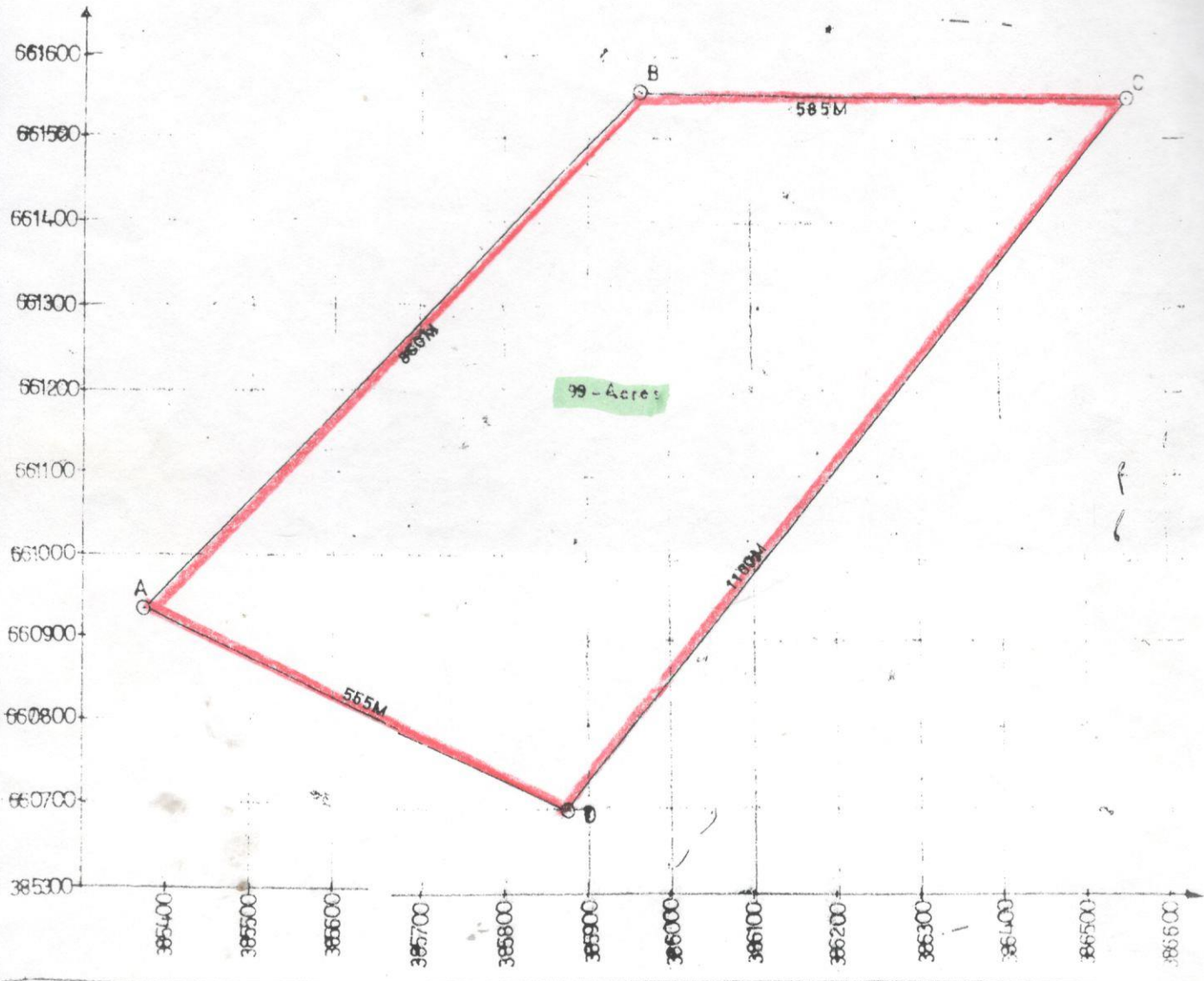

*OK*  
*Quinn*

Scale = 1 : 500M

BUREAU OF MINES			UTM - COORDINATES		
DESCRIPTION	NAMES / SIGNATURE	DATE	sta.	Easting	Northing
Surveyed by:	Arnold N. Wah <i>[Signature]</i>	03-04-2020	A	385375	660938
Checked by:	Alexander C. Roberts <i>[Signature]</i>	03-22-2020	B	385969	661553
Approved by:	Wellington Kyelett <i>[Signature]</i>	01-12-2022	C	386569	661550
			D	385877	660582

# Revenue Collection Detailed Report

Bureau: All  
 Period: 1/1/2020 - 7/4/2023  
 Taxpayer: INLAND INVESTMENT  
 Tax Code: All  
 Taxpayer Category: All

Tax Payer	TIN	Tax Code	Tax Kind	Date	USD	LD	Bill No	BPS No	Receipt No	Check No	Categ	Req. Period	End Period
INLAND INVESTMENT INC. / BUCHANAN TBO / DEC.		111141-RUR	RURAL WH on salaries and wages (residents)	12/31/2020	40.00	0.00	091465	803530	245589	ECO/349348		10/1/2020	10/31/2020
HAO ZHANJU / INLAND INVESTMENT INC.	500733986	142173-BIN	BIN - Resident permit of renewal (non ECOWAS)	11/21/2022	350.00	0.00	30947	721451	543043			11/21/2022	11/21/2023
HAO ZHANJU / INLAND INVESTMENT INC.	500733986	142171-BIN	BIN - Resident permit (non ECOWAS)	11/17/2020	750.00	0.00	45915	955671	540299	IB/00083921	G	11/17/2020	11/17/2021
INLAND INVESTMENT INC. / BUCHANNA TBO OCT 2021		111131-RUR	RURAL Presumptive tax (200c) for small taxpayers (4%)	12/1/2021	200.00	0.00	112203	808431	250803	ECOUSD/46701		1/1/2021	3/31/2021
INLAND INVESTMENT INC. / BUCHANNA TBO OCT 2021		111141-RUR	RURAL WH on salaries and wages (residents)	12/1/2021	23.00	0.00	112206	808432	250804	ECOUSD/46701		8/31/2021	
INLAND INVESTMENT INC. / BUCHANNA TBO OCT 2021		111141-RUR	RURAL WH on salaries and wages (residents)	12/1/2021	23.00	0.00	112209	808432	250804	ECOUSD/46701		10/1/2021	
INLAND INVESTMENT INC. / BUCHANNA TBO OCT 2021		111141-RUR	RURAL WH on salaries and wages (residents)	12/1/2021	23.00	0.00	112213	808432	250804	ECOUSD/46701		10/8/2021	
INLAND INVESTMENT INC. / BUCHANNA TBO OCT 2021		111142-RUR	RURAL Withholding on rent (residents)	12/1/2021	35.00	0.00	112219	808433	250805	ECOUSD/46701		10/8/2021	10/8/2022
INLAND INVESTMENT INC. / BUCHANNA TBO OCT 2021		111142-RUR	RURAL Withholding on rent (residents)	12/1/2021	40.00	0.00	112214	808432	250804	ECOUSD/46701		10/8/2021	10/8/2022
INLAND INVESTMENT INC. / BUCHANNA TBO OCT 2021		111142-RUR	RURAL Withholding on rent (residents)	12/1/2021	35.00	0.00	112216	808433	250805	ECOUSD/46701		10/8/2021	10/8/2022
INLAND INVESTMENT INC. / BUCHANNA TBO OCT 2021		111142-RUR	RURAL Withholding on rent (residents)	12/1/2021	35.00	0.00	112217	808433	250805	ECOUSD/46701		10/8/2021	10/8/2022
INLAND INVESTMENT INC. / BUCHANNA TBO OCT 2021		111142-RUR	RURAL Withholding on rent (residents)	12/1/2021	35.00	0.00	112218	808433	250805	ECOUSD/46701		10/8/2021	10/8/2022
INLAND INVESTMENT INC. / BUCHANNA TBO OCT 2021		111142-RUR	RURAL Withholding on rent (residents)	12/1/2021	35.00	0.00	112221	808433	250805	ECOUSD/46701		10/8/2021	10/8/2022
INLAND INVESTMENT INC. / BUCHANAN TBO / DEC.		111131-RUR	RURAL Presumptive tax (200c) for small taxpayers (4%)	12/31/2020	20.00	0.00	091460	803530	245588	ECO/349348		7/1/2018	9/30/2018
INLAND INVESTMENT INC.	500733986	114599	Other fees/licenses	5/30/2022	10,000.00	0.00	000000	052391	81838	UBAL/00064737	S	2/1/2022	1/31/2023
INLAND INVESTMENT INC.	500733986	142208-LBR	LBR - Re-registration fee	9/14/2022	0.00	4,000.00	000000	054394	885059		S	6/1/2022	5/31/2023
INLAND INVESTMENT INC.	500733986	111141	WH (Res.) on salaries and wages	10/13/2022	34.40	0.00	000000	054657	885900		S	9/1/2022	9/30/2022
INLAND INVESTMENT INC.	500733986	111141	WH (Res.) on salaries and wages	10/13/2022	34.40	0.00	000000	054658	885900		S	8/1/2022	8/31/2022
INLAND INVESTMENT INC.	500733986	111141	WH (Res.) on salaries and wages	10/13/2022	34.40	0.00	000000	054658	885900		S	7/1/2022	7/30/2022
INLAND INVESTMENT INC.	500733986	111141	WH (Res.) on salaries and wages	10/13/2022	34.40	0.00	000000	054658	885900		S	6/1/2022	6/30/2022
INLAND INVESTMENT INC.	500733986	111141	WH (Res.) on salaries and wages	10/13/2022	34.40	0.00	000000	054657	885900		S	5/1/2022	5/30/2022
INLAND INVESTMENT INC.	500733986	111141	WH (Res.) on salaries and wages	10/13/2022	34.40	0.00	000000	054657	885900		S	4/4/2022	4/30/2022



Revenue Collection Detailed Report

All  
1/1/2020 - 7/4/2023  
INLAND INVESTMENT  
All  
All  
Category: All

Tax Payer	TIN	Tax Code	Tax Kind	Date	USD	LD	Bill No	BPS No	Receipt No	Check No	Categ	Beg. Period	End Period
MENT INC /	500733986	142102-MFA	MFA - Amendment of Articles of Incorporation	6/5/2023	10.00	0.00	0000000	057737	S91513		S	1/1/2023	12/31/2023
MENT INC /	500733986	142208-LBR	LBR - Re-registration fee	11/26/2020	0.00	5,000.00	0000000	036428	S64672		G	1/1/2020	12/31/2020
MENT INC /	500733986	142208-LBR	LBR - Re-registration fee	1/20/2021	0.00	4,000.00	0000000	038066	S65930		G	1/1/2021	12/31/2021
MENT INC /		111111-RUR	RURAL PIT for residents (200a)	12/31/2020	25.00	0.00	091461	803530	245588	ECC/349348		10/1/2018	12/31/2018
MENT INC /		111131-RUR	RURAL Presumptive tax (200c) for small taxpayers (4%)	12/31/2020	120.00	0.00	091462	803530	245588	ECC/349348		1/1/2017	3/31/2017
MENT INC /		111131-RUR	RURAL Presumptive tax (200c) for small taxpayers (4%)	12/31/2020	40.00	0.00	091463	803530	245589	ECC/349348		4/1/2017	6/30/2017
MENT INC /		111131-RUR	RURAL Presumptive tax (200c) for small taxpayers (4%)	12/31/2020	120.00	0.00	091464	803530	245589	ECC/349348		7/1/2017	9/30/2017
MENT INC /		111131-RUR	RURAL Presumptive tax (200c) for small taxpayers (4%)	12/31/2020	20.00	0.00	091454	803529	245590	ECC/349348		1/1/2019	3/31/2019
MENT INC /		111131-RUR	RURAL Presumptive tax (200c) for small taxpayers (4%)	12/31/2020	20.00	0.00	091455	803529	245590	ECC/349348		3/1/2019	6/30/2019
MENT INC /		111131-RUR	RURAL Presumptive tax (200c) for small taxpayers (4%)	12/31/2020	15.00	0.00	091457	803529	245591	ECC/349348		10/1/2019	12/31/2019
MENT INC /		111131-RUR	RURAL Presumptive tax (200c) for small taxpayers (4%)	12/31/2020	20.00	0.00	091456	803529	245588	ECC/349348		7/1/2020	9/30/2020
MENT INC /		111131-RUR	RURAL Presumptive tax (200c) for small taxpayers (4%)	12/31/2020	20.00	0.00	091459	803530	245588	ECC/349348		4/1/2018	6/30/2018
MENT INC /		141113-RUR	Resident permit of renewal (not for MVA)	11/15/2021	350.00	0.00	21130	714856	541645	IBL/00098300		11/15/2021	11/15/2022
MENT INC /		142208-LBR	LBR - Re-registration fee	4/21/2021	1,000.00	0.00	26782	712050	484592	IBL/00090228	G	4/21/2021	4/21/2022
MENT INC /		142208-LBR	LBR - Re-registration fee	5/19/2022	1,000.00	0.00	29610	718175	485232	UBA/00061876		5/19/2022	5/19/2023
MENT INC /		142208-LBR	LBR - Re-registration fee	3/7/2022	1,000.00	0.00	28691	716622	485073	UBA/00042709		3/7/2022	3/7/2023
					<b>28,634.46</b>	<b>13,000.00</b>							

# INLAND INVESTMENT INC.

BUCHANAN HIGHWAY  
BUCHANAN CITY, GRAND BASSA COUNTY  
REPUBLIC OF LIBERIA

November 20, 2023

Hon. Gesler E. Murray  
**MINISTER**  
Ministry of Mines and Energy  
Capitol Hill, Monrovia  
Republic of Liberia



Dear Hon. Murray:

I bring you compliments and wish to apply for the annual renewal of my Class B Sand Mining License (AM2005020).

I would appreciate your timely consideration of this application to enable us to maintain a legal operation.

Thanks for your usual cooperation as we strive to better the mineral sector of Liberia.

Sincerely yours,

George S. Kaliku  
**MANAGER**  
INLAND INVESTMENT INC.

Dimonele  
23/11/2023  
Renewal/AM 2005020